

Treetops of Madeira • The Austin
7206 Treetops Lane • \$699,000



11025 Reed Hartman Hwy.
Cincinnati, OH 45242
513.745.9019
johnhenryhomes.com



Because we are constantly improving our product, we reserve the right to change product features, brand names, dimensions, architectural details & design. This brochure is for illustrative purposes only & is in no way part of a legal, binding contract. Floor plans vary by elevation. Front entry garage is standard. Brick wrap will affect room dimensions. ©2017 John Henry Homes Inc.

Features:

- Approximately 3252 Sq. Ft.
- 3 Car Garage
- 9' 1st Floor Ceilings
- 9' Lower Level
- 2 Story Great Room
- 3 1/2 Baths
- Gas Fireplace
- Beamed Ceiling
- Garden Bath
- Walk-in Shower
- Custom Built-ins
- Stone Fireplace

Price Also Includes

- Aristokraft Korbet Cabinets
- Quiet Close Cabinets
- Quartz Countertops
- Gourmet Kitchen
- Samsung Appliances
- Hardwood Kitchen
- Hardwood Dining Room
- Hardwood Study
- Stained Oak Steps
- Smooth Ceilings
- Picture Framed Windows
- Designer Backsplash
- Tile Floors Baths and Laundry
- Upgraded Moen Voss Faucets

Call (513) 226-7219 for more information
or visit us today at johnhenryhomes.com

Treetops of Madeira • \$699,000

The Austin

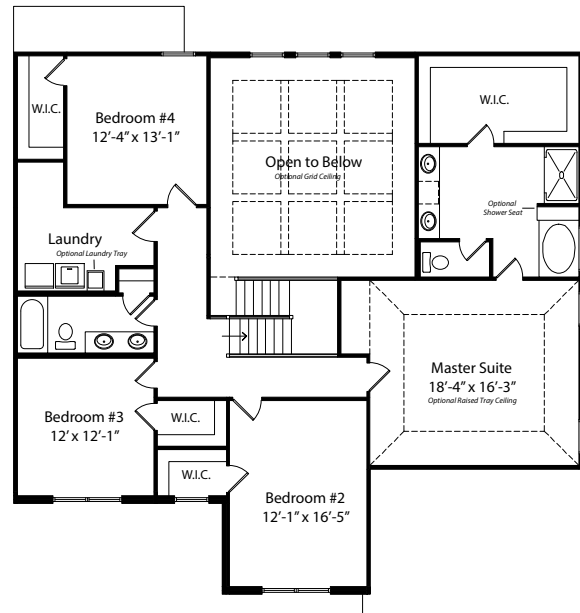
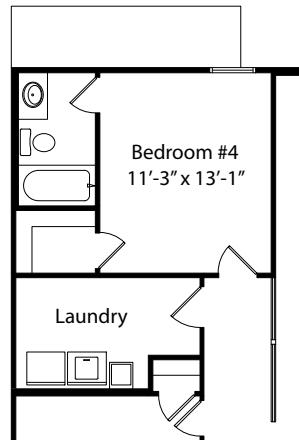
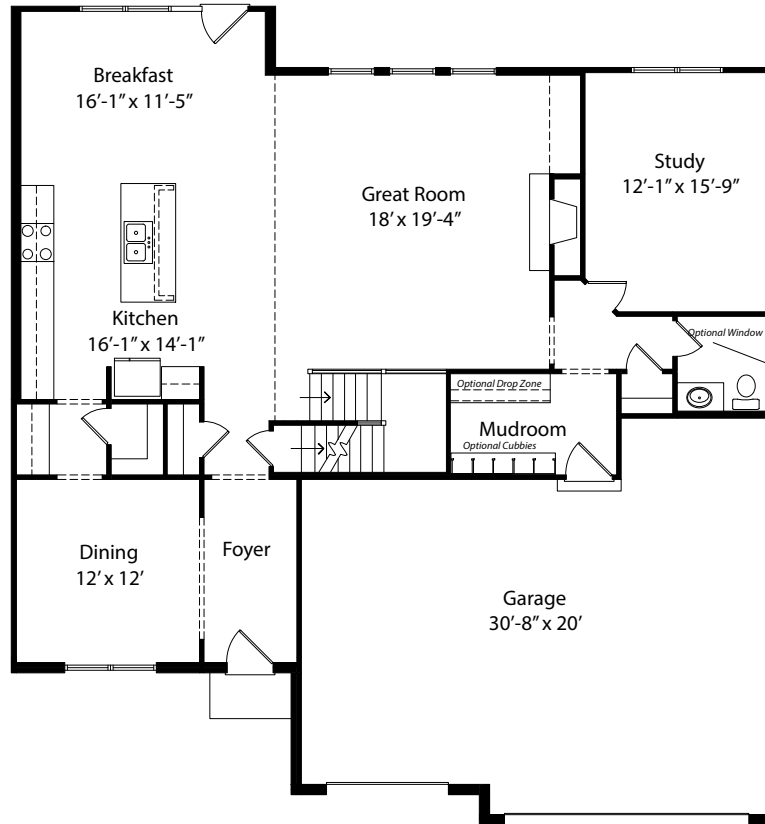

11025 Reed Hartman Hwy.
Cincinnati, OH 45242
513.745.9019
johnhenryhomes.com



Because we are constantly improving our product, we reserve the right to change product features, brand names, dimensions, architectural details & design. This brochure is for illustrative purposes only & is in no way part of a legal, binding contract. Floor plans vary by elevation. Front entry garage is standard. Brick wrap will affect room dimensions. ©2017 John Henry Homes Inc.