

ROBERTS PARK

Neighborhood Plan

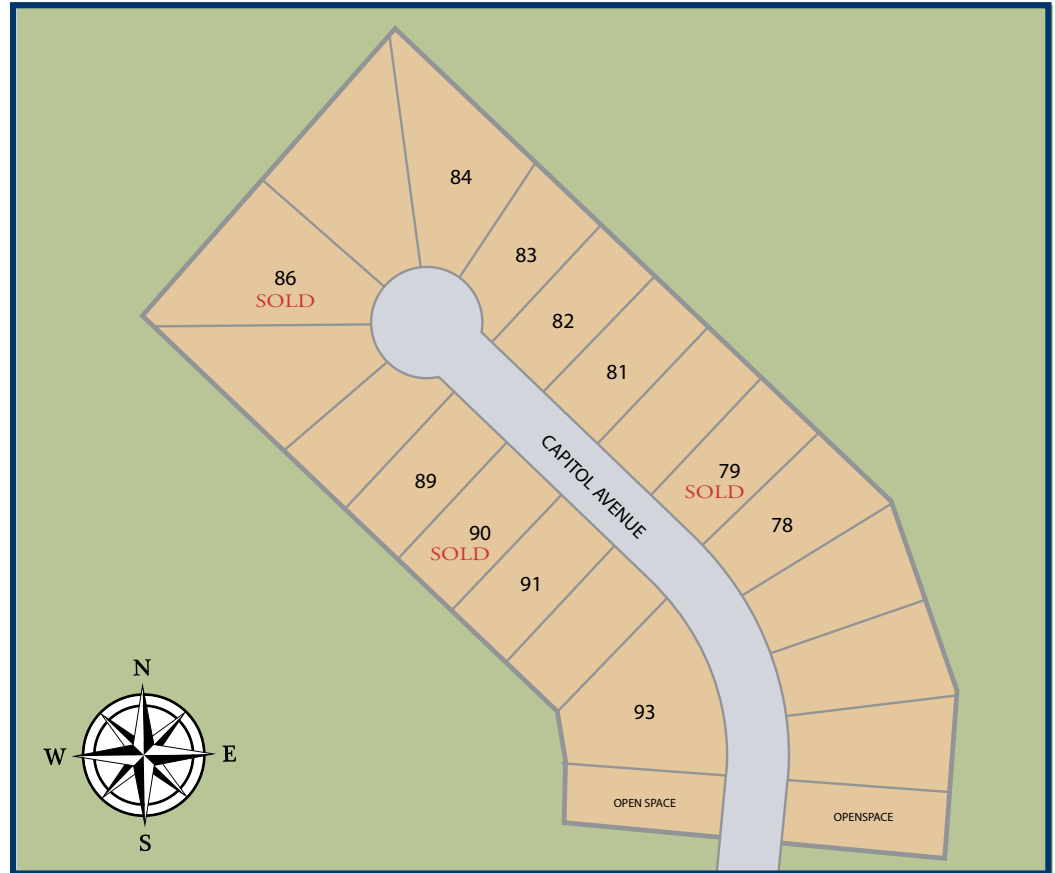

FEATURES:

- Mason Schools
- Convenient to 71, 75 and Liberty Way
- Includes Social Membership Status to Four Bridges
- Surrounded by 80 Acre Community Park
- Walking Trails
- Street trees & Street lights

DIRECTIONS:

I-75 to Liberty Way Exit, East on Liberty Way, Left on Butler Warren, Right on Bethany, Left on Heritage Point Boulevard (Heritage Point Community), Right on Capitol Avenue

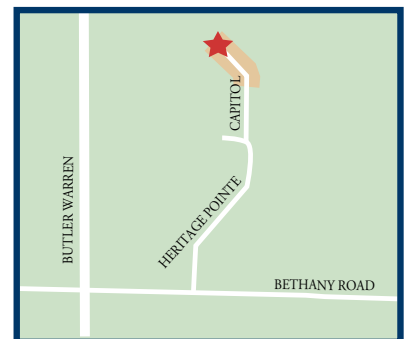

For more information call

513-310-9779

johnhenryhomes.com

ROBERTS PARK

PUBLIC SCHOOLS:

- Mason Early Child Center (PK-1) 398-3741
- Western Row Elementary (2-3) 398-5821
- Mason Intermediate School (4-6): 459-2850
- Mason Middle School (7-8): 398-9035
- Mason High School (9-12): 398-5025

PRIVATE & PAROCHIAL SCHOOLS:

- St. Susanna (1-8): 398-3821
- Moeller High School (9-12): 791-1680
- Mt. Notre Dame High School (9-12): 821-3044
- Ursuline Academy (9-12): 791-5791
- Rockwern Academy (PreK-6): 984-3770

SHOPPING:

- Harpers Station:
- Kenwood Mall: 745-9100
- Tri-County Mall: 671-0120
- Kroger: 398-8680
- Kings Auto Mall: 855-593-0095
- Deerfield Towne Center: 770-0273

PARKS:

- Mason Parks Department: 398-3056
- Warren County Park District: 261-1109

UTILITIES:

- Cincinnati Bell: 565-2210
- Duke Energy: 800-544-6900
- Warren County Water & Sewer: 695-1377
- Greater Cincinnati Water Works: 591-7700

EMERGENCY SERVICES:

- Fire, Police & Rescue: 911
- Bethesda North Hospital: 745-1111
- Jewish Mason Medical Center: 459-6200
- Mason Police Non-Emergency: 932-4080
- Mason Fire Non-Emergency: 398-2041
- Children's Hospital Lbrty Campus: 803-9600
- UC West Chester Hospital: 298-3000

RECREATION:

- Mason Community Center: 398-3056
- Paramount's Kings Island: 754-5700
- The Beach Water Park: 398-7946
- Golf Center at Kings Island: 398-7700
- Countryside YMCA: 932-1424
- Lou Eves-Mason Municipal Pool: 697-1812
- Regal Cinema Deerfield Ctr: 844-462-7342
- Great Wolf Lodge: 459-8885

Community Information



11025 Reed Hartman Hwy
Cincinnati, Oh 45242
513.745.9019
johnhenryhomes.com

