



City of Madeira • The Jackson

7239 Thomas Lane • \$639,900



Design Features and Decorator Choices:

- Approximately 3007 Sq. Ft.
- 9' 1st Floor Ceilings
- 9' Basement Walls
- Gas Fireplace with Stone Surround
- Built-in Cubbies in Mud Room
- American Scrape Oak First Floor
- Quartz Counter Tops in Kitchen & Master Bath
- Luxurious Walk-in Shower
- Rain Shower in Owner's Bath
- Craftsman Style Stair Rails
- Laundry Sink & Cabinet
- Gourmet Kitchen
- Aristokraft Winstead Cabinets
- Quiet Close Cabinets - Kitchen
- GE Profile Stainless Steel Appliances
 - Gas Range
 - Smooth Ceilings
 - Designer Tile Backsplash
- Tile Floors Baths and Laundry
 - Oak Treads Stairs
 - Moen Voss Faucets
- Stained Fiberglass Front Door
 - Pendant Lights at Island
 - Recessed Lighting

**COLDWELL
BANKER**

WEST SHELL



BUILD
COLLECTIVE

**john henry
HOMES**

Because we are constantly improving our product, we reserve the right to change product features, brand names, dimensions, architectural details & design. This brochure is for illustrative purposes only & is in no way part of a legal, binding contract. Floor plans vary by elevation. Front entry garage is standard. Brick wrap will affect room dimensions.
©2019 John Henry Homes Inc.

Call (513) 260-0424 for more information
or visit us today at johnhenryhomes.com

City of Madeira • \$639,900

7239 Thomas Lane

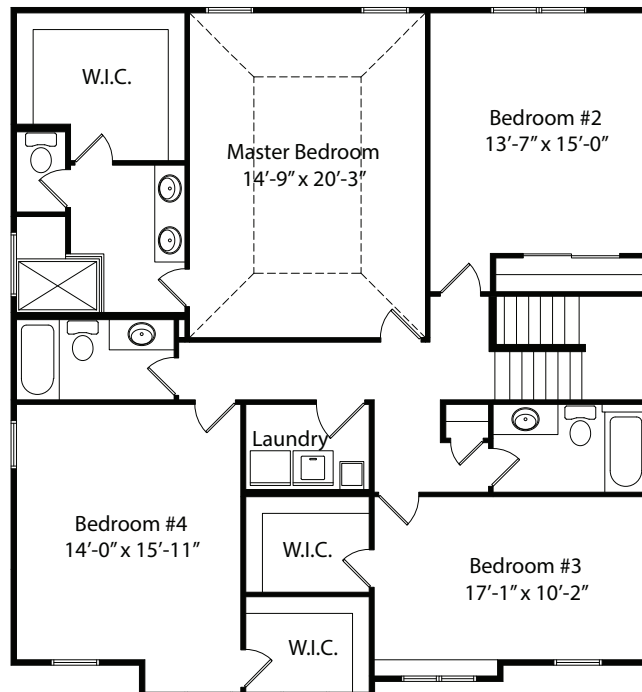
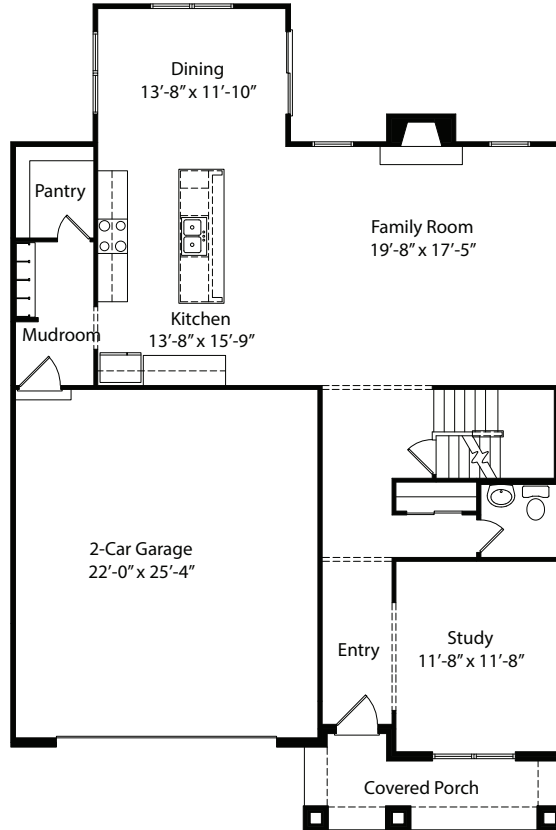

11025 Reed Hartman Hwy.
Cincinnati, OH 45242
513.745.9019
johnhenryhomes.com



Because we are constantly improving our product, we reserve the right to change product features, brand names, dimensions, architectural details & design. This brochure is for illustrative purposes only & is in no way part of a legal, binding contract. Floor plans vary by elevation. Front entry garage is standard. Brick wrap will affect room dimensions. ©2019 John Henry Homes Inc.