



City of Madeira • The Jackson

7128 Mayfield Avenue • \$660,000



Design Features and Decorator Choices:

- Approximately 3007 Sq. Ft.
- 9' 1st Floor Ceilings
- 9' Basement Walls
- Gas Fireplace with Stone Surround
- Quartz Tops in Kitchen & Owner's Bath
 - Smooth Ceilings
- Built-in Cubbies in Mud Room
 - Luxurious Walk-in Shower
- Rain Shower in Owner's Bath
- Craftsman Style Stair Rails
- Laundry Sink & Cabinet
- Stained Fiberglass Front Door
 - 63 Estimated HERS
- Gourmet Kitchen
 - Aristokraft Winstead Cabinets
- American Scrape Oak First Floor
- American Scrape Oak First Floor
- Quiet Close Kitchen Cabinets
- GE Profile Stainless Appliances
 - Gas Range
- Designer Tile Backsplash
- Tile Floors Baths and Laundry
 - Oak Treads Stairs
 - Moen Voss Faucets
 - Pendant Lights at Island
- LED Recessed Style Lighting



Because we are constantly improving our product, we reserve the right to change product features, brand names, dimensions, architectural details & design. This brochure is for illustrative purposes only & is in no way part of a legal, binding contract. Floor plans vary by elevation. Front entry garage is standard. Brick wrap will affect room dimensions.
©2019 John Henry Homes Inc.

Call (513) 260-0424 for more information
or visit us today at johnhenryhomes.com

City of Madeira • \$660,000

7128 Mayfield Avenue

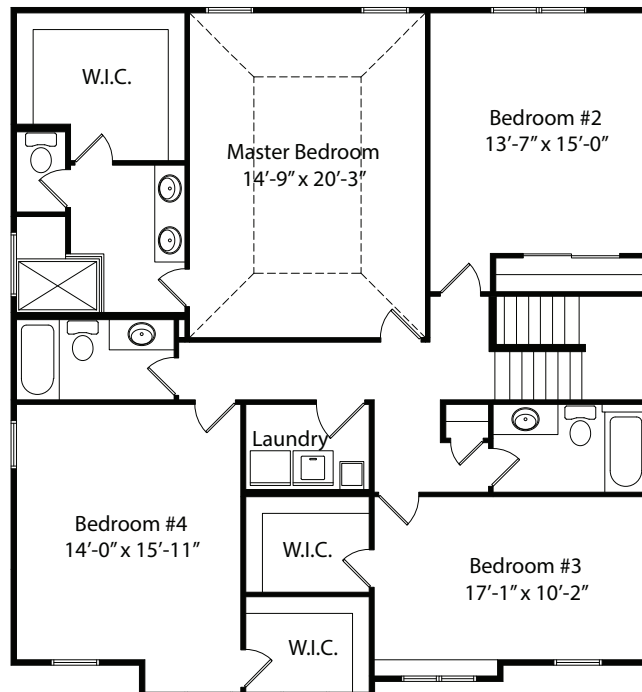
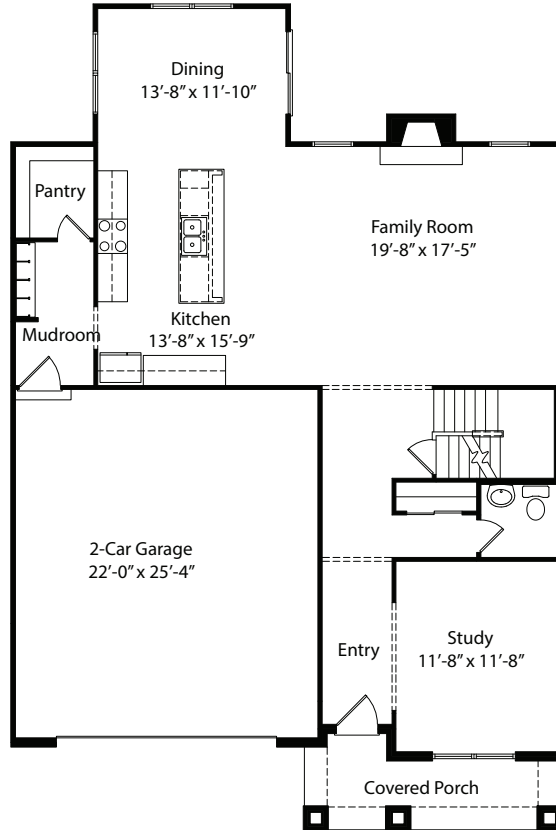

11025 Reed Hartman Hwy.
Cincinnati, OH 45242
513.745.9019
johnhenryhomes.com



Because we are constantly improving our product, we reserve the right to change product features, brand names, dimensions, architectural details & design. This brochure is for illustrative purposes only & is in no way part of a legal, binding contract. Floor plans vary by elevation. Front entry garage is standard. Brick wrap will affect room dimensions. ©2019 John Henry Homes Inc.